

B.E.G.**LUXOMAT®**

PD4N-CAS DALI-2

Prod.No. 93473 EAN: 4007529934737

- Voltage: 230 V AC $\pm 10\%$ 50 Hz
- Dimensions: \varnothing 106 x 95 mm
- Settings: Casambi App

Order data

Designation	Colour	Art.No
PD4N-CAS DALI-2	white	93473

Accessories

Designation	Colour	Art.No
SM socle mounting set IP54 PD4N H	anthracite	93786
SM socle mounting set IP54 PD4N H	white	93465
SM socle mounting set IP54 PD4N H	black	93788
SM socle mounting set IP54 PD4N H	traffic white	93787
SM socle mounting set IP65 PD4N	white	93314
Corridor lens PD4N type A, Cover ring	traffic white	93742
Corridor lens PD4N type A, Cover ring	anthracite	93741
Corridor lens PD4N type A, Cover ring	black	93743
Corridor lens PD4N type A	white	93073

lens PD4N, Cover ring	anthracite	93731
lens PD4N, Cover ring	black	93733
lens PD4N, Cover ring	traffic white	93732
Wire basket BSK (Ø 200 x 90 mm)	white	92199
Wall holder PD2N/4N Typ A	white	93164

Technical data

Voltage:	230 V AC $\pm 10\%$ 50 Hz
Dimensions:	Ø 106 x 95 mm
Settings:	Casambi App
Power consumption:	0.5 W
Detection area:	horizontal 360° oval (Ceiling mounting) max. Ø 24 m across
Range:	max. Ø 8 m towards max. Ø 6.4 m seated
Monitored area (tangential movement):	450 m ² / 2.5 m mounting height
Mounting height min./max./recommended:	2 m / 10 m / 2.5 m
Degree / class of protection:	IP20 / Class II
Impact strength:	IK04
Ambient temperature:	-5 °C to +45 °C
Housing:	polycarbonate, UV-resistant
Material color:	white mat, similar to RAL9010
Number of PIR sensors:	4
Channel 1 (lighting control)	
	80 mA (guaranteed), 125 mA (max.), shut down mechanism
DALI output:	
Supported control gear:	DT0, DT5, DT6, DT7, DT8
Supported control devices:	- (single master)
Follow-up time:	1 sec – 60 min
Brightness set value:	1 – 4000 Lux
Light measuring:	Mixed light measuring

Product information

Casambi-enabled occupancy detector

DALI-2 interface for controlling digital dimmable ECGs in broadcast/multicast mode

Integrated temperature monitoring and short-circuit detection

Version as single-master device, can be networked wirelessly

DALI output power can be increased with accessories

Bright LED indication for commissioning

Mixed light measurement with internal and external light sensor

Weighting between internal and external light sensor can be adapted to suit the application

Adjustment of the reflection factor and input of the luminosity for the display of the actual luminosity in the app

Extension of the detection area with additional B.E.G. Casambi devices possible

Individual adaption of detection sensitivity for each PIR sensor

Detection area can be restricted with blinds

Functions adjustable via Casambi app

Including pre-assembled spring clamp with strain relief and contact protection cap for recessed ceiling mounting

Accessory for surface mounting available

Accessories for wall mounting optionally available

Further accessories for colour matching optionally available

Application examples:

entrance halls, corridors/hallways, open-plan offices, conference rooms, classrooms/seminar rooms, sports halls/ storage rooms, underground car parks, staircases, toilets, equipment rooms, small offices

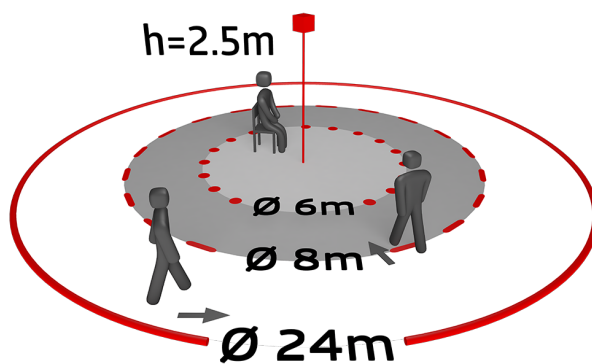
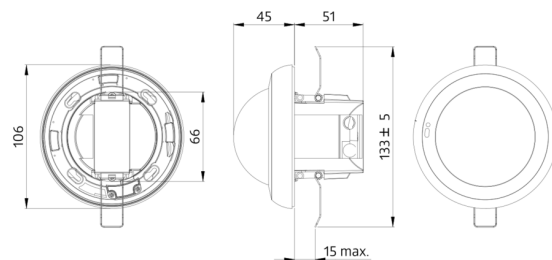

CASAMBI

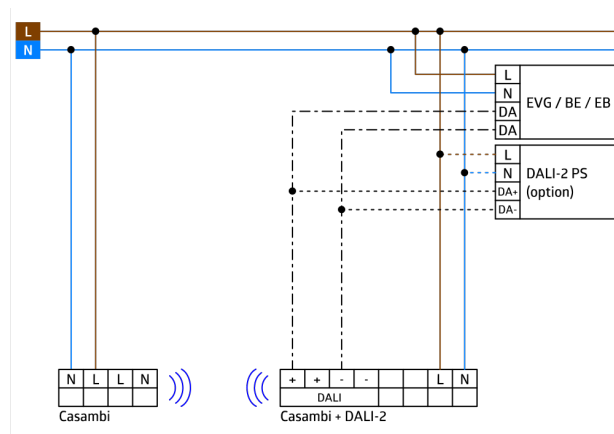

Accessories



SM socle mounting set IP54 PD4N H

Art.No: 93786

Dimensions: Ø 110 x 45 mm
Degree / class of protection: IP54
Material color: anthracite, similar to RAL7016



SM socle mounting set IP54 PD4N H

Art.No: 93465

Dimensions: Ø 110 x 45 mm
Degree / class of protection: IP54
Material color: white, similar to RAL9010



SM socle mounting set IP54 PD4N H

Art.No: 93788

Dimensions: Ø 110 x 45 mm
Degree / class of protection: IP54
Material color: black, similar to RAL9005



SM socle mounting set IP54 PD4N H

Art.No: 93787

Dimensions: Ø 110 x 45 mm
Degree / class of protection: IP54
Material color: traffic white, similar to RAL9016



SM socle mounting set IP65 PD4N

Art.No: 93314

Dimensions: 133 x 133 x 69 mm
Degree / class of protection: IP65
Material color: white



Corridor lens PD4N type A, Cover ring

Art.No: 93742

Detection area: horizontal 360°
(Ceiling mounting)
Range: max. Ø 40 m
across
max. Ø 20 m
towards
Monitored area (tangential
movement): 250 m² / 2.5 m
mounting height



Corridor lens PD4N type A, Cover ring

Art.No: 93741

Detection area: horizontal 360°
(Ceiling mounting)
Range: max. Ø 40 m
across
max. Ø 20 m
towards
Monitored area (tangential
movement): 250 m² / 2.5 m mounting
height



Corridor lens PD4N type A, Cover ring

Art.No: 93743

Detection area: horizontal 360°
(Ceiling mounting)
Range: max. Ø 40 m
across
max. Ø 20 m
towards
Monitored area (tangential
movement): 250 m² / 2.5 m
mounting height



Corridor lens PD4N type A

Art.No: 93073

Detection area: horizontal 360°
(Ceiling mounting)
Range: max. Ø 40 m
across
max. Ø 20 m
towards
Monitored area (tangential
movement): 250 m² / 2.5 m
mounting height



lens PD4N, Cover ring

Art.No: 93731

Detection area: horizontal 360° (Ceiling
mounting)
Range: max. Ø 24 m
across
max. Ø 8 m
towards
max. Ø 6.4 m
seated
Monitored area (tangential movement):
450 m² / 2.5 m mounting height



lens PD4N, Cover ring

Art.No: 93733

Detection area: horizontal 360° (Ceiling
mounting)
Range: max. Ø 24 m
across
max. Ø 8 m
towards
max. Ø 6.4 m
seated
Monitored area (tangential movement):
450 m² / 2.5 m mounting height



lens PD4N, Cover ring

Art.No: 93732

Detection area: horizontal 360° (Ceiling
mounting)
Range: max. Ø 24 m
across
max. Ø 8 m
towards
max. Ø 6.4 m
seated
Monitored area (tangential movement):
450 m² / 2.5 m mounting height

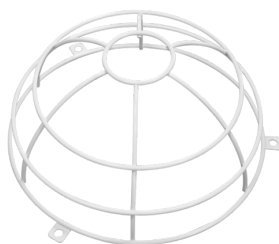

Wire basket BSK (Ø 200 x 90 mm)

Art.No: 92199

Dimensions: Ø 200 x 90 mm
Impact strength: IK09
Housing: coated steel basket



Wall holder PD2N/4N Typ A

Art.No: 93164

Dimensions: 133 x 106 x 66 mm
Degree / class of protection: IP54
Housing: polycarbonate, UV-resistant