

B.E.G.**LUXOMAT®**

PD2-S-FM

Prod.No. 92156 EAN: 4007529921560

- Voltage: 110 – 240 V AC 50 / 60 Hz
- Dimensions: Ø 98 x 65 mm
- Power consumption: approx. 0.2 W

Order data

Designation	Colour	Art.No
PD2-S-FM	white	92156

Accessories

Designation	Colour	Art.No
BLE-IR-Adapter	black	93067
Wire basket BSK (Ø 200 x 90 mm)	white	92199
Blinds PD2-SM		92260

Technical data

Voltage:	110 – 240 V AC 50 / 60 Hz
Dimensions:	Ø 98 x 65 mm
Power consumption:	approx. 0.2 W
Detection area:	horizontal 360° (Ceiling mounting) max. Ø 10 m across max. Ø 6 m towards max. Ø 4 m seated
Range:	78 m² / 2.5 m mounting height
Monitored area (tangential movement):	2 m / 5 m / 2.5 m
Mounting height min./max./recommended:	IP20 / Class II
Degree / class of protection:	IK05
Impact strength:	-25 °C to +50 °C
Ambient temperature:	polycarbonate, UV-resistant
Housing:	white mat, similar to RAL9010
Material color:	2 or 9 sec
Pulse interval:	

Product information

Slave device detector with circular detection area

For extending the detection area of a Master device

Trigger pulse to master device upon detected movement independent of the ambient light level

Compatible with 230 V devices. Concerning exceptions please see the respective master device.

Application examples:

small offices, staircases, open-plan offices, conference rooms, classrooms/seminar rooms

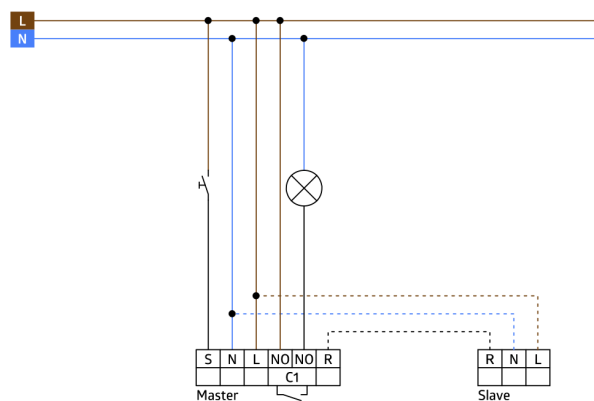
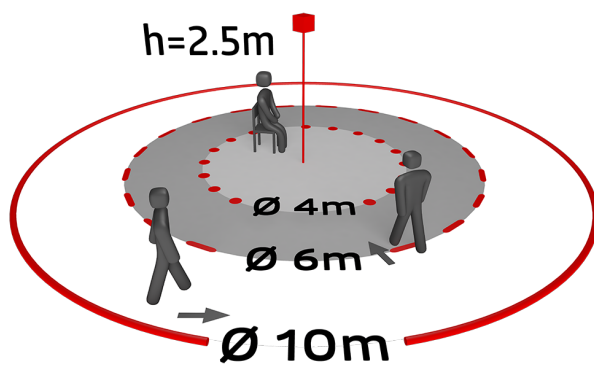
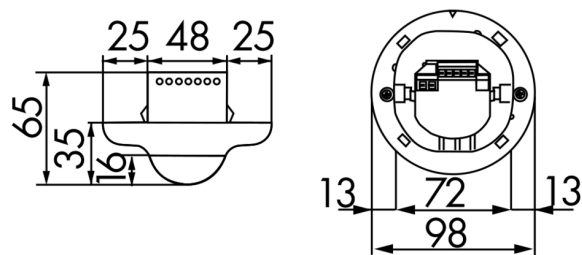

Accessories



BLE-IR-Adapter

Art.No: 93067

Dimensions: 40 x 55 x 103 mm

Material color: black

Frequency: 2.4 GHz ISM band, GFSK 0.2
dBm + 5.3 dBi = 5.5 dBm

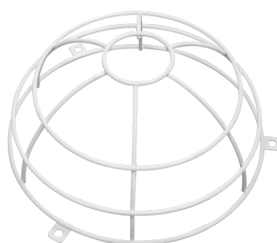

Wire basket BSK (Ø 200 x 90 mm)

Art.No: 92199

Dimensions: Ø 200 x 90 mm

Impact strength: IK09

Housing: coated steel basket



Blinds PD2-SM

Art.No: 92260

Housing: Housing UV- and
shockresistant Polycarbonate
Material color: transparent