

**B.E.G.****LUXOMAT®**

## PD9-1C-12-48V-FC Set 92985-92958-92238

- Voltage: 12 - 48 V AC / DC
- Dimensions: Sensor head: Ø 45 x 37 mm,  
Power supply: 165 x 24 x 24 mm
- Power consumption: < 0.25 W

### Areas of application

- entrance halls
- corridors/hallways
- small offices

### Order data

Designation	Colour	Art.No
PD9-1C-12-48V-FC	white	92985
Cover IP65 for Sensor head PD9	transparent	92958
Cover ring PD9 Ø 36 mm	white	92238

## Technical data

Voltage:	12 - 48 V AC / DC
Dimensions:	Sensor head: Ø 45 x 37 mm, Power supply: 165 x 24 x 24 mm
Power consumption:	< 0.25 W
Detection area:	horizontal 360° (Ceiling mounting) max. Ø 10 m across
Range:	max. Ø 6 m towards max. Ø 4 m seated
Monitored area (tangential movement):	78 m <sup>2</sup> / 2.5 m mounting height
Mounting height min./max./recommended:	2 m / 5 m / 2.5 m
Degree / class of protection:	<b>IP20 / Class II + IP65 (92958)</b>
Impact strength:	IK03
Ambient temperature:	-25 °C to +50 °C
Housing:	polycarbonate, UV-resistant
Material color:	<b>white glossy (92238)</b>
Cable length:	45 cm
<b>Channel 1 (lighting control, potential-free (dry))</b>	
Switching power:	1000 W, cos φ = 1 800 W LED max. inrush current I <sub>p</sub> (20 ms) = 165 A max. inrush current I <sub>p</sub> (200 μs) = 800 A
Type of contact (k):	1x μ-contact, dry NO contact with tungsten pre-make contact
Follow-up time:	30 sec - 30 min, Pulse
Switch-on threshold:	10 - 2000 Lux

## Product information

Set : PD9-1C-12-48V-FC + Cover IP65 for Sensor head PD9 transparent + Cover ring PD9 Ø 36 mm white glossy

Mini-motion detector with operating voltage 12-48 V

One channel for light switching

Easy installation on device

Power supply passes through the hole in the ceiling for the detector (34 mm Ø)

Spring clips for quick and easy installation in suspended ceilings and light fittings

Includes 45 mm cover ring and blinds



power supply

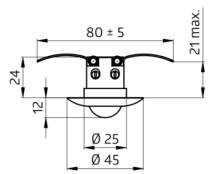

sensor head



## Set items

To receive the bundle according to the technical specification, please order the items listed.



### **PD9-1C-12-48V-FC**

Art.No: 92985

Voltage: 12 – 48 V AC / DC

Dimensions: Sensor head: Ø 45 x 37 mm,

Power supply: 165 x 24 x 24 mm

Power consumption: < 0.25 W



### **Cover IP65 for Sensor head PD9**

Art.No: 92958

Degree / class of protection: IP65

Housing: UV-resistant

Material color: transparent



### **Cover ring PD9 Ø 36 mm**

Art.No: 92238

Dimensions: Ø 36 mm

Housing: polycarbonate, UV-resistant

Material color: white glossy