

**B.E.G.****LUXOMAT®**

## PD4N-M-DACO-1C DALI-2 Set 93463-93787

- Voltage: 230 V AC  $\pm 10\%$  50 Hz
- Dimensions:  $\varnothing 106 \times 95 \text{ mm} + \varnothing 110 \times 45 \text{ mm}$  (93787)
- Power consumption: approx. 2 W

### Areas of application

- entrance halls
- corridors/hallways
- small offices
- open-plan offices
- conference rooms
- classrooms/seminar rooms
- sports halls/ storage rooms

### Order data

Designation	Colour	Art.No
PD4N-M-DACO-1C DALI-2	white	93463
SM socle mounting set IP54 PD4N H	traffic white	93787

## Technical data

Voltage:	230 V AC $\pm 10\%$ 50 Hz
Dimensions:	<b><math>\varnothing 106 \times 95</math> mm + <math>\varnothing 110 \times 45</math> mm (93787)</b>
Power consumption:	approx. 2 W
Slave devices:	up to 8
Detection area:	horizontal 360° (Ceiling mounting) max. $\varnothing 24$ m across max. $\varnothing 8$ m towards max. $\varnothing 6.4$ m seated
Range:	
Monitored area (tangential movement):	450 m <sup>2</sup> / 2.5 m mounting height
Mounting height min./max./recommended:	2 m / 10 m / 2.5 m
Degree / class of protection:	<b>IP54 (93787)</b>
Impact strength:	IK04
Ambient temperature:	-25 °C to +50 °C
Housing:	polycarbonate, UV-resistant <b>traffic white, similar to RAL9016 (93787)</b>
Material color:	

### Channel 1 (lighting control)

DALI output:	80 mA (guaranteed), 125 mA (max.), Shut-down mechanism
Supported control gear:	DT0, DT5, DT6, DT7
Supported control devices:	- (single master)
Follow-up time:	1 min - 150 min
Orientation light:	10 - 30 % / OFF / 5 min - 60 min / $\infty$
Brightness set value:	10 - 2500 Lux

### Channel 2 (HVAC or lighting control)

Switching power:	2300 W, $\cos \varphi$ = 1 1150 VA, $\cos \varphi$ = 0.5 800 W LED max. inrush current $I_p$ (20 ms) = 165 A
------------------	---

## Product information

Set : PD4N-M-DACO-1C DALI-2 + SM socle mounting set IP54 PD4N H traffic white, similar to RAL9016

Occupancy detector with integrated DALI application controller for energy-efficient lighting control

DALI-2 certified product

Integrated DALI power supply

DALI interface for controlling digital, dimmable ECGs in broadcast mode

Manual switching or dimming via conventional pushbuttons

Bidirectional IR communication enables fast integration into the project management function of the B.E.G. One app

Complete range of functions can only be activated using the BLE-IR-Adapter and a compatible Smartphone or Tablet (Android, iOS).

Semi-automatic, full automatic, presence-independent or light-independent mode adjustable

Powerful switching relay for different operating modes, e.g. Cut-off function for DALI ballasts, HVAC, blackboard illumination.

Adjustable regulation dynamics (minimum and maximum values)

Adjustable speed and delay of the regulation

Single master version, not networkable

Detection area can be extended by using slave devices

Mixed light measurement with internal and external light sensor

DALI output power can be increased with accessories

Integrated daylight harvesting circuit (or switch output)

Adjustable switch-on value

Last value - Reminder function for switch-on value

Adjustable brightness set value and reflection factor

Indication of the current light sensor value in the B.E.G. One App

Self-check and display of device errors in the B.E.G. One App

Status LEDs can be activated / deactivated

PIN code

Corridor function - Deactivates the possibility to switch off the light via the push-button

Number of DALI participants can be determined quickly and

Type of contact: 1x  $\mu$ -contact,  
dry, bistable

Follow-up time: 5 min – 120  
min, Alarm  
pulse, Pulse

Light measuring: Mixed light  
measuring

reliably via the B.E.G. Online DALI Line Planner

Avoidance of standby losses of the lighting system in  
accordance with EnEV DIN V 18599-4

Software is backwards compatible with the first generation  
(except DSI, double lock and corridor function)

Factory setting 10 min follow-up time and 500 lux brightness  
set value

Including pre-assembled spring clamp with strain relief and  
contact protection cap for recessed ceiling mounting

Accessory for surface mounting available

Accessories for wall mounting optionally available

Further accessories for colour matching optionally available

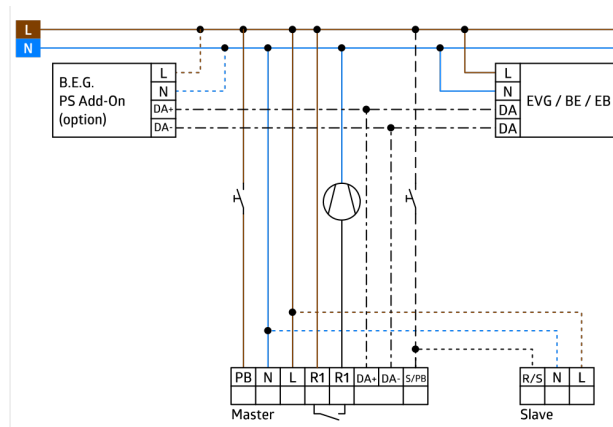
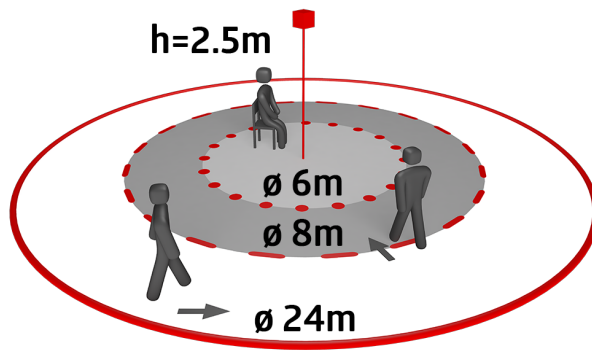
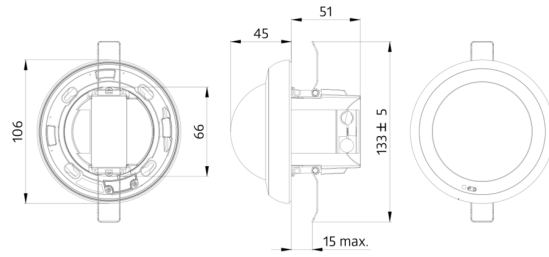

## Set items

To receive the bundle according to the technical specification, please order the items listed.



### **PD4N-M-DACO-1C DALI-2**

Art.No: 93463

Voltage: 230 V AC  $\pm 10\%$  50 Hz

Dimensions:  $\varnothing$  106 x 95 mm

Power consumption: approx. 2 W



### **SM socle mounting set IP54 PD4N H**

Art.No: 93787

Dimensions:  $\varnothing$  110 x 45 mm

Degree / class of protection: IP54

Material color: traffic white, similar to RAL9016