

**B.E.G.****LUXOMAT®**

## PD2N-M-1C-LED-FC

Prod.No. 94055 EAN: 4007529940554

- Voltage: 110 - 240 V AC 50 / 60 Hz
- Dimensions: Ø 84 x 85 mm
- Luminous flux / intensity: LED circuit board securely mounted  
Luminous flux of light 90 lm

### Areas of application

- corridors/hallways
- entrance halls
- staircases
- small offices

### Order data

Designation	Colour	Art.No
PD2N-M-1C-LED-FC	white	94055

### Accessories

Designation	Colour	Art.No
BLE-IR-Adapter	black	93067
IR-PD-Mini	-	92159
RC-Arc extinction kit	white	10880
Mini-RC-Arc extinction kit		10882
Blinds PD2N/PD3N		37367

## Technical data

Voltage:	110 - 240 V AC 50 / 60 Hz
Dimensions:	Ø 84 x 85 mm LED circuit board securely mounted
Luminous flux / intensity:	Luminous flux of light 90 lm approx. 0.3 W / approx. 2 W with LED
Power consumption:	horizontal 360° (Ceiling mounting)
Detection area:	max. Ø 10 m across max. Ø 6 m towards max. Ø 4 m seated
Range:	
Monitored area (tangential movement):	78 m <sup>2</sup> / 2.5 m mounting height
Mounting height min./max./recommended:	2 m / 5 m / 2.5 m
Degree / class of protection:	IP20 / Class II
Impact strength:	IK03
Ambient temperature:	-20 °C to +40 °C
Housing:	Polycarbonate Semi-automatic mode, Slave mode, Full automatic mode, Fully automatic with Corridor
Operation mode:	
Material color:	white mat, similar to RAL9010

### Channel 1 (lighting control, potential-free (dry))

Switching power:	2300 W, $\cos \varphi = 1$ 1150 VA, $\cos \varphi = 0.5$ 800 W LED max. inrush current $I_p$ (20 ms) = 165 A max. inrush current $I_p$ (200 $\mu$ s) = 800 A 1x $\mu$ -contact, dry NO contact with tungsten pre-make contact
Type of contact (k):	
Follow-up time:	10 sec - 18 h

## Product information

Remote control-capable occupancy detector for inside use  
with circular detection area

Integrated LED light as separately adjustable orientation- and  
night light

One channel for light switching

Numerous setting and readout options via the bidirectional  
B.E.G. smartphone app

Extension of the detection range possible by using up to 5  
other PD2N-M-1C-LED

Can be used as either Master device or Slave device

### Application examples:

corridors/hallways, entrance halls, staircases, small offices

Orientation light: 20 - 100 % / OFF / 10 s - 18 h

Night light: 20 - 100 % / 10 sec - 18 h / ∞

Switch-on threshold: 10 - 2000 Lux

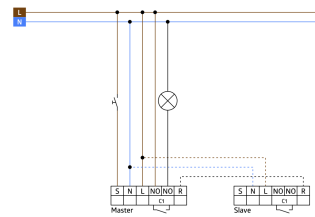
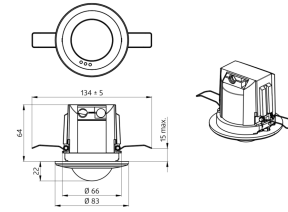

## Accessories



### BLE-IR-Adapter

Art.No: 93067

Dimensions: 40 x 55 x 103 mm

Material color: black

Frequency: 2.4 GHz ISM band, GFSK 0.2 dBm + 5.3 dBi = 5.5 dBm



### IR-PD-Mini

Art.No: 92159

Battery: 3.0 V Lithium CR2032 (inclusive)

Dimensions: 57 x 35 x 7 mm

Material color: -



### RC-Arc extinction kit

Art.No: 10880

Voltage: 230 V AC  $\pm 10\%$

Dimensions: 38 x 12 x 26 mm

Degree / class of protection: IP20 / Class II



### Mini-RC-Arc extinction kit

Art.No: 10882

Voltage: 230 V AC  $\pm 10\%$

Dimensions: 50 x 23 x 8 mm

Degree / class of protection: IP20 / Class II

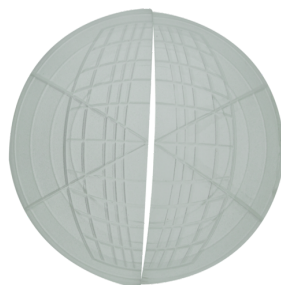

### Blinds PD2N/PD3N

Art.No: 37367

Housing: ABS