

**B.E.G.****LUXOMAT<sup>®</sup>net**

## PD2-KNX-FC

Prod.No. 92881 EAN: 4007529928811

- Voltage: via KNX BUS
- Dimensions: Ø 80 x 84.5 mm
- Typ. power input: 7 mA

### Order data

Designation	Colour	Art.No
PD2-KNX-FC		92881

### Accessories

Designation	Colour	Art.No
BLE-IR-Adapter	black	93067
IR-Adapter for Smartphones	black	92726
IR-PD-KNX	-	92123
Wire basket BSK (Ø 200 x 90 mm)	white	92199
SM socket IP54 for PD2- / PD4-SM	white	92161

## Technical data

Voltage:	via KNX BUS
Dimensions:	Ø 80 x 84.5 mm
Typ. power input:	7 mA
Detection area:	horizontal 360° (Ceiling mounting)
Range:	max. Ø 10 m across max. Ø 6 m towards max. Ø 4 m seated
Monitored area (tangential movement):	78 m <sup>2</sup> / 2.5 m mounting height
Mounting height min./max./recommended:	2 m / 5 m / 2.5 m
Degree / class of protection:	IP20 / Class II
Ambient temperature:	-25 °C to +55 °C
Housing:	polycarbonate, UV-resistant
Material color:	white mat, similar to RAL9010
Brightness set value:	5 – 1200 Lux
Light measuring:	Mixed light measuring

## Product information

KNX occupancy detector with integrated KNX bus connector

When using the product database

B.E.G.\_Praesenzmelder\_928xx\_V5.0, the following operation modes are available: 1. Full automatic mode 2. Semi-automatic mode 3. Slave mode 4. Occupancy-independent regulating mode

Detectors with firmware version 4 are not compatible with the new software.

The software is available for free download on the B.E.G. homepage. All detectors use the same software.

Up to three additional switching channels – selectively either daylight-dependent or not

Set values and follow-up times can be changed for all channels using communication objects

Burn-in function with adjustable burn-in time from 1 to 100 hours

With activatable motion LED, deactivatable via ETS parameter, communication object or remote control

Settings via ETS 3 and 4

The product database for import into the ETS database can be downloaded from the B.E.G. homepage.

### Typical applications:

Offices, conference rooms, schools, nursery schools, hospitals

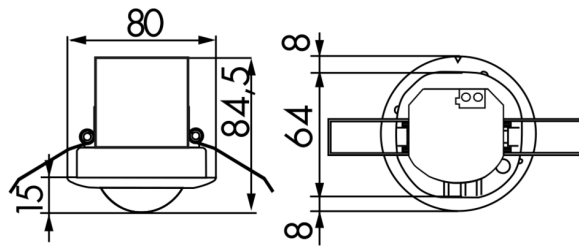

## Accessories



### BLE-IR-Adapter

Art.No: 93067

Dimensions: 40 x 55 x 103 mm

Material color: black

Frequency: 2.4 GHz ISM band, GFSK 0.2 dBm + 5.3 dBi = 5.5 dBm

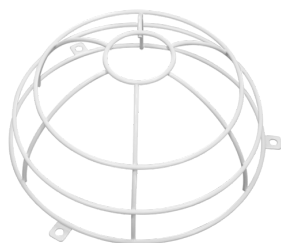

### Wire basket BSK (Ø 200 x 90 mm)

Art.No: 92199

Dimensions: Ø 200 x 90 mm

Impact strength: IK09

Housing: coated steel basket



### IR-Adapter for Smartphones

Art.No: 92726

Dimensions: 47 x 19 x 10 mm

Degree / class of protection: IP20

Ambient temperature: -20 °C to +40 °C



### IR-PD-KNX

Art.No: 92123

Battery: 3.0 V Lithium CR2032 (inclusive)

Dimensions: 80 x 60 x 8 mm

Material color: -



### SM socket IP54 for PD2- / PD4-SM

Art.No: 92161

Dimensions: Ø 100 x 15 mm

Degree / class of protection: IP54

Housing: polycarbonate, UV-resistant