

B.E.G.**LUXOMAT®**

Indoor 180-M-2C covering not included Set 92661-92632

- Voltage: 110 - 240 V AC 50 / 60 Hz
- Dimensions: covering not included 70 x 70 x 61 mm
- Power consumption: approx. 0.4 W

Areas of application

- corridors/hallways
- toilets
- staircases
- conference rooms

Order data

Designation	Colour	Art.No
Indoor 180-M-2C covering not included	-	92661
Frame IP20 Indoor 180	oyster white	92632

Technical data

Voltage:	110 - 240 V AC 50 / 60 Hz
Dimensions:	covering not included 70 x 70 x 61 mm
Power consumption:	approx. 0.4 W
Detection area:	horizontal 180° (Wall mounting)
Range:	max. 10 m across max. 3 m towards
Monitored area (tangential movement):	150 m ² / 1.1 m mounting height
Mounting height min./max./recommended:	1 m / 2.2 m / 1.1 m
Degree / class of protection:	IP20 / Class II
Impact strength:	IK05
Ambient temperature:	-25 °C to +50 °C
Housing:	polycarbonate, UV-resistant
Material color:	oyster white mat, similar to RAL1013 (92632)

Channel 1 (lighting control)

Switching power:	2300 W, $\cos \varphi$ = 1 1150 VA, $\cos \varphi$ = 0.5 800 W LED max. inrush current I_p (20 ms) = 165 A max. inrush current I_p (200 μ s) = 800 A
Type of contact (k):	1x μ -contact, NO contact with tungsten pre- make contact
Follow-up time:	15 sec - 30 min, Pulse
Switch-on threshold:	10 - 2000 Lux

Channel 2 (HVAC control potential-free (dry))

Switching power:	3 A (230 V), \cos φ = 1
Type of contact:	1x μ -contact, dry NO contact
Follow-up time:	5 min - 120 min, Alarm pulse, Pulse

Product information

Set : Indoor 180-M-2C covering not included + Frame
IP20 Indoor 180 oyster white mat, similar to RAL1013

Wall occupancy detector with acoustic sensor

One channel for light switching

One additional potential-free (dry) contact for HVAC

Version as master device

Detection area can be extended by using slave devices

Acoustic sensor independently adjustable

Noise automatically extends follow-up time

Available with covering (centre plate dimensions 60 x 60 mm)
or without covering for use with covering (centre plate
dimensions 50 x 50 mm) in 5 different colours

In combination with centre plates usable with current frame
systems of various manufacturers

B.E.G. frames and centre plates for combination with other
frame systems available

Factory settings 10 min and 500 lux (15 min HVAC)

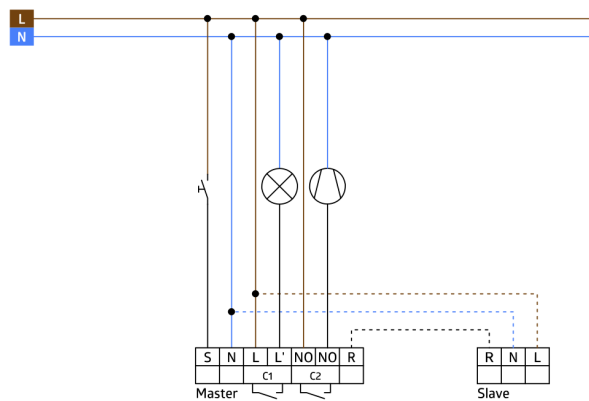
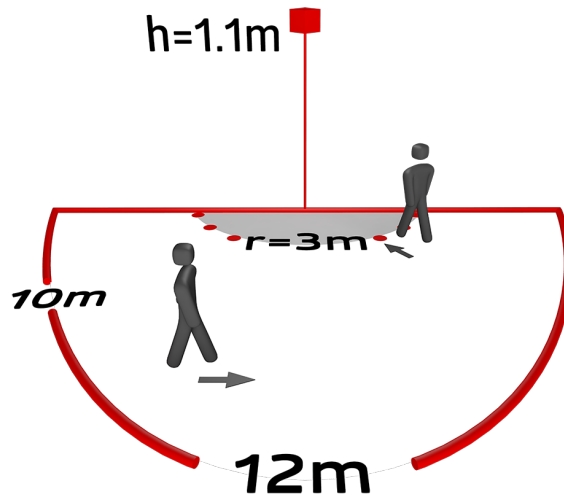
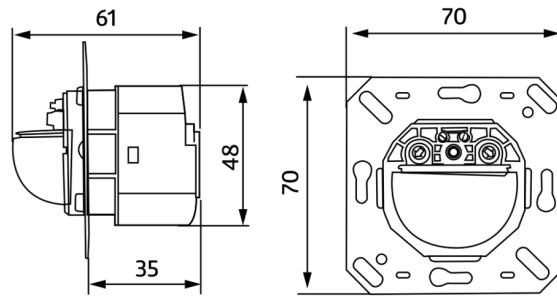

Set items

To receive the bundle according to the technical specification, please order the items listed.



Indoor 180-M-2C covering not included

Art.No: 92661

Voltage: 110 – 240 V AC 50 / 60 Hz

Dimensions: covering not included 70 x 70 x 61 mm

Power consumption: approx. 0.4 W



Frame IP20 Indoor 180

Art.No: 92632

Dimensions: 86 x 86 mm

Degree / class of protection: IP20

Housing: polycarbonate, UV-resistant