

## Ceiling mounted occupancy detectors - 2-channel

### PD2-M-2C



white mat, similar to  
RAL9010 , Part No. 92150

white mat, similar to  
RAL9010 , Part No. 92155

white mat, similar to  
RAL9010 , Part No. 92165

### Product Information

- Occupancy detector with circular detection area
- One channel for light switching
- One additional potential-free (dry) contact for HVAC
- Version as master device
- Detection area can be extended with slave devices
- Manual switching via push-button possible
- Alarm pulse: the detector triggers only when three movements are detected within 9 seconds
- Additional functions can be set up using the optional remote control.
- Factory settings 10 min and 500 lux (15 min HVAC)
- Zero crossing switching
- **Application examples:**  
corridors/hallways, staircases, toilets, equipment rooms, small offices, open-plan offices, conference rooms

### Technical Data

<b>Voltage:</b>	110 - 240 V AC 50 / 60 Hz
<b>Dimensions:</b>	FM= Ø 98 x 65 mm SM= Ø 98 x 47 mm FC= Ø 80 x 85 mm
<b>Power consumption:</b>	approx. 0.5 W
<b>Detection area:</b>	horizontal 360° (Ceiling mounting)

<b>Range:</b>	max. Ø 10 m across max. Ø 6 m towards max. Ø 4 m seated
<b>Monitored area (tangential movement):</b>	78 m <sup>2</sup> / 2.5 m mounting height
<b>Mounting height min./max./recommended:</b>	2 m / 5 m / 2.5 m
<b>Degree / class of protection:</b>	FM= IP20 / Class II SM= IP20 / Class II FC= IP20 / Class II
<b>Impact strength:</b>	IK05
<b>Ambient temperature:</b>	-25 °C to +50 °C
<b>Housing:</b>	polycarbonate, UV-resistant

#### **Channel 1 (lighting control)**

<b>Switching power:</b>	2300 W, cos $\varphi$ = 1 1150 VA, cos $\varphi$ = 0.5 300 W LED max. inrush current I <sub>p</sub> (20 ms) = 165 A max. inrush current I <sub>p</sub> (200 $\mu$ s) = 800 A
<b>Type of contact:</b>	1x $\mu$ -contact, NO contact with tungsten pre-make contact
<b>Follow-up time:</b>	15 sec - 30 min, Pulse
<b>Switch-on threshold:</b>	10 - 2000 Lux

#### **Channel 2 (HVAC control potential-free (dry))**

<b>Switching power:</b>	3 A (230 V), cos $\varphi$ = 1
<b>Type of contact:</b>	1x $\mu$ -contact, dry NO contact
<b>Follow-up time:</b>	5 min - 120 min, Alarm pulse, Pulse Mixed light measuring

---

## Description

<b>Description</b>	<b>Colour</b>	<b>Part number</b>	<b>EAN number</b>
PD2-M-2C-SM	white mat, similar to RAL9010	92150	4007529921508
PD2-M-2C-FM	white mat, similar to RAL9010	92155	4007529921553
PD2-M-2C-FC	white mat, similar to RAL9010	92165	4007529921652

---

## Accessory

Description	Colour	Part number	EAN number
BLE-IR-Adapter	black	93067	4007529930678
IR-PD-2C	-	92475	4007529924752
IR-PD-Mini	-	92159	4007529921591
Wire basket BSK (Ø 200 x 90 mm)	white	92199	4007529921997
RC-Arc extinction kit	white	10880	4007529108800
Mini-RC-Arc extinction kit	black	10882	4007529108824
SM socket IP54 for PD2- / PD4-SM	white	92161	4007529921614

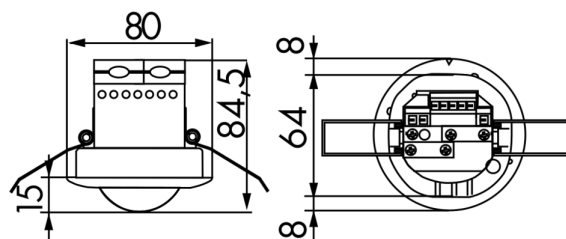
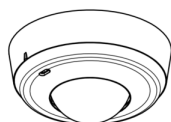
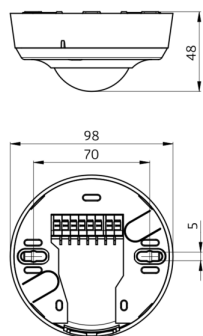

Dimensions 92150

Dimensions 92165

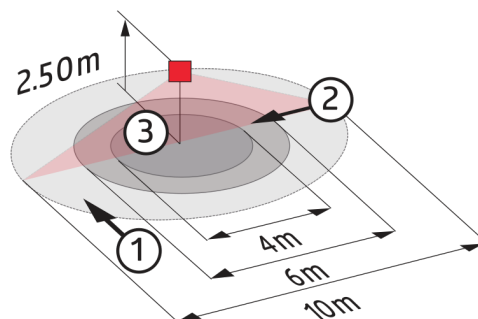
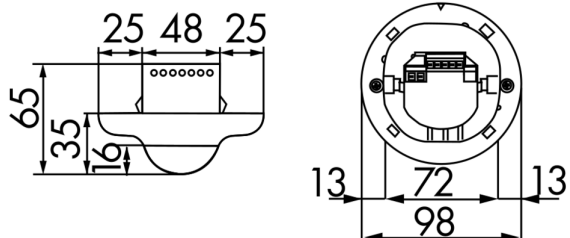

Dimensions 92155

Range diagram  
1: Walking across

2: Walking towards

3: Seated activity

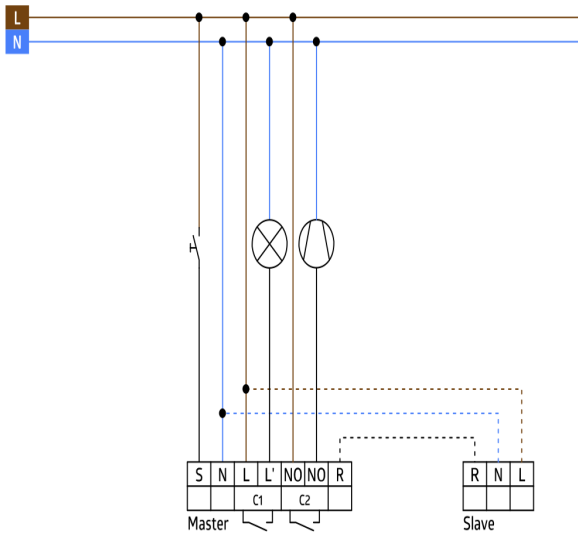

Wiring diagrams

---

© 2023 B.E.G. Brück Electronic GmbH