

B.E.G. LUXOMAT® net



PD4N-CAS Set 93474-93741-92199

- Voltage: 230 V AC \pm 10% 50 Hz
- Dimensions: \varnothing 200 x 90 mm (92199)
- Settings: Casambi App

Order data

Designation	Colour	Art.No
PD4N-CAS	white	93474
Corridor lens PD4N type A, Cover ring	anthracite	93741
Wire basket BSK (\varnothing 200 x 90 mm)	white	92199

Technical data

Voltage:	230 V AC ±10% 50 Hz
Dimensions:	Ø 200 x 90 mm (92199)
Settings:	Casambi App
Power consumption:	0.5 W
Detection area:	horizontal 360° (Ceiling mounting) (93741) max. Ø 40 m across max. Ø 20 m towards (93741)
Range:	250 m² / 2.5 m mounting height (93741)
Monitored area (tangential movement):	2.4 m / 2.6 m / 2.5 m (93741)
Mounting height min./max./recommended:	2.4 m / 2.6 m / 2.5 m (93741)
Degree / class of protection:	IP20 / Class II
Impact strength:	IK09 (92199)
Ambient temperature:	-5 °C to +45 °C
Housing:	polycarbonate, UV-resistant + coated steel basket (92199) anthracite mat, similar to RAL7016 (93741)
Material color:	
Number of PIR sensors:	4
	Channel 1 (lighting control)
Follow-up time:	1 sec – 60 min
Brightness set value:	1 – 4000 Lux
Light measuring:	Mixed light measuring

Product information

Set : PD4N-CAS + Corridor lens PD4N type A, Cover ring anthracite mat, similar to RAL7016 + Wire basket BSK (Ø 200 x 90 mm) white

Casambi-enabled occupancy detector

Bright LED indication for commissioning

Mixed light measurement with internal and external light sensor

Weighting between internal and external light sensor can be adapted to suit the application

Adjustment of the reflection factor and input of the luminosity for the display of the actual luminosity in the app

Extension of the detection area with additional B.E.G. Casambi devices possible

Individual adaption of detection sensitivity for each PIR sensor

Detection area can be restricted with blinds

Functions adjustable via Casambi app

Including pre-assembled spring clamp with strain relief and contact protection cap for recessed ceiling mounting

Accessory for surface mounting available

Accessories for wall mounting optionally available

Further accessories for colour matching optionally available

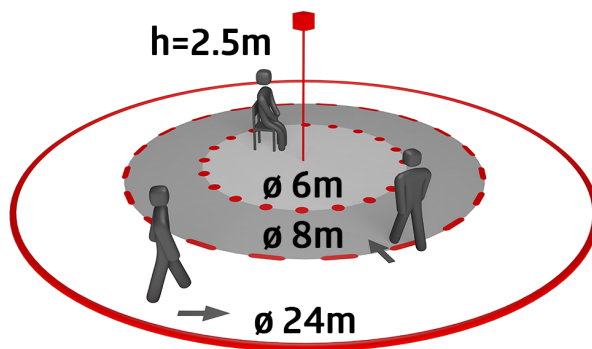
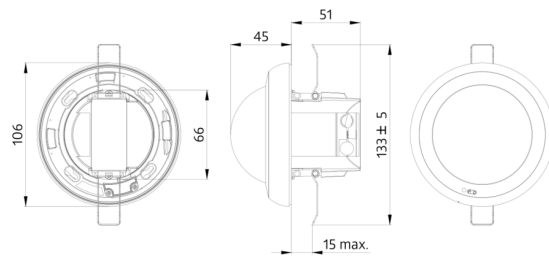

CASAMBI

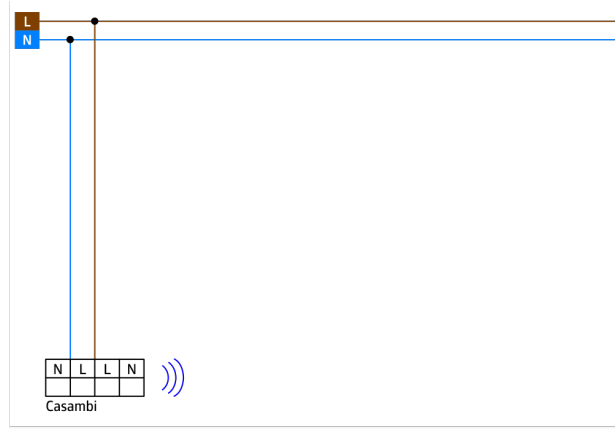

Set items

To receive the bundle according to the technical specification, please order the items listed.



PD4N-CAS

Art.No: 93474

Voltage: 230 V AC $\pm 10\%$ 50 Hz

Dimensions: \varnothing 106 x 95 mm

Settings: Casambi App



Corridor lens PD4N type A, Cover ring

Art.No: 93741

Detection area: horizontal 360° (Ceiling mounting)

Range: max. \varnothing 40 m across

max. \varnothing 20 m towards

Monitored area (tangential movement): 250 m² / 2.5 m mounting height

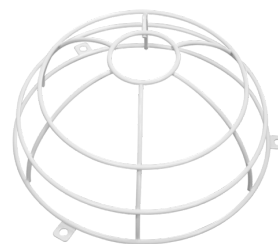

Wire basket BSK (\varnothing 200 x 90 mm)

Art.No: 92199

Dimensions: \varnothing 200 x 90 mm

Impact strength: IK09

Housing: coated steel basket