

**B.E.G.****LUXOMAT®**

## PD4-S-DAA4G-FC Set 92721-92199

- Voltage: 22 V DC via DALI Bus
- Dimensions: **Ø 200 x 90 mm (92199)**
- Detection area: horizontal 360° (Ceiling mounting)

### Order data

| Designation                     | Colour | Art.No |
|---------------------------------|--------|--------|
| PD4-S-DAA4G-FC                  | white  | 92721  |
| Wire basket BSK (Ø 200 x 90 mm) | white  | 92199  |

## Technical data

|   |  |
|---|--|
| Voltage:  | 22 V DC via DALI Bus   |
| Dimensions:   | <b>Ø 200 x 90 mm (92199)</b>   |
| Detection area:   | horizontal 360°<br>(Ceiling mounting)<br>max. Ø 24 m across<br>max. Ø 8 m towards seated |
| Range:  | max. Ø 6.4 m seated  |
| Monitored area (tangential movement):                     | 450 m <sup>2</sup> / 2.5 m mounting height   |
| Mounting height min./max./recommended:                    | 2 m / 10 m / 2.5 m   |
| Degree / class of protection:                             | IP20 / Class II  |
| Impact strength:  | <b>IK09 (92199)</b>  |
| Ambient temperature:                                      | -25 °C to +50 °C   |
| Housing:  | <b>polycarbonate, UV-resistant + coated steel basket (92199)</b>                         |
| Material color:   | white mat, similar to RAL9010  |
| up to 4 slave devices in combination with one PD4-M-DAA4G |  |
| Pulse interval:   | 30 sec (in test mode 2 sec during 3 min)   |

## Product information

Set : PD4-S-DAA4G-FC + Wire basket BSK (Ø 200 x 90 mm) white

DALI bus operated slave device

For extension of the detection area of a master device PD4-M-DAA4G / PD4-M-HCL

Trigger pulse to master device upon detected movement independent of the ambient light level

Automatic test mode via master device

Plug & Play - no parameterisation required

Easy to mount

False ceiling or surface mount version available

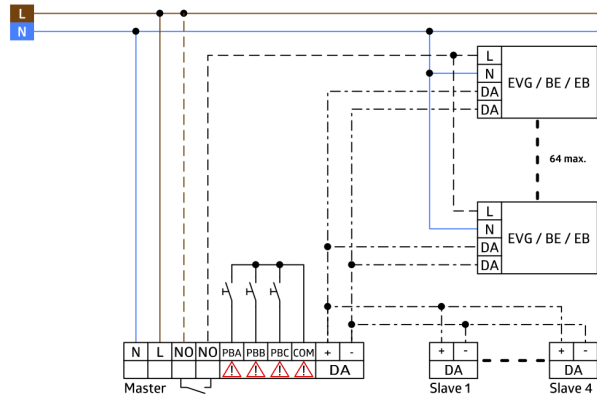
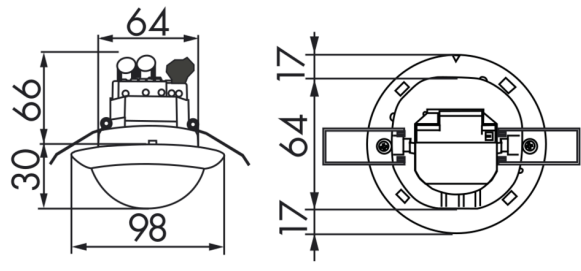

## Set items

To receive the bundle according to the technical specification, please order the items listed.



### **PD4-S-DAA4G-FC**

Art.No: 92721

Voltage: 22 V DC via DALI Bus

Dimensions: Ø 98 x 96 mm

Detection area: horizontal 360° (Ceiling mounting)



### **Wire basket BSK (Ø 200 x 90 mm)**

Art.No: 92199

Dimensions: Ø 200 x 90 mm

Impact strength: IK09

Housing: coated steel basket