

B.E.G.**LUXOMAT®**

PD4-M-1C-C-PS-FC Set 92480-92199-92992

Occupancy detector with NO contact and safety circuit by NC contact

Guarantees illumination even if sensor fails

Designed for corridors

Areas of application

- corridors/hallways

Order data

Designation	Colour	Art.No
PD4-M-1C-C-PS-FC	white	92480
Wire basket BSK (Ø 200 x 90 mm)	white	92199
Square design frame PD4-FC	pure white	92992

Technical data

Voltage:	110 - 240 V AC 50 / 60 Hz
Dimensions:	Ø 200 x 90 mm (92199)
Power consumption:	approx. 0.7 W horizontal 360°
Detection area:	(Ceiling mounting) max. Ø 40 m across max. Ø 20 m towards
Range:	
Monitored area (tangential movement):	250 m ² / 2.5 m mounting height
Mounting height min./max./recommended:	2.4 m / 2.6 m / 2.5 m
Degree / class of protection:	IP20 / Class II
Impact strength:	IK09 (92199)
Ambient temperature:	-25 °C to +50 °C
Housing:	polycarbonate, UV-resistant + coated steel basket (92199)
Material color:	white mat, similar to RAL9010

Channel 1 (lighting control)

Switching power:	2300 W, $\cos \varphi = 1$ 1150 VA, $\cos \varphi = 0.5$ 800 W LED max. inrush current I_p (20 ms) = 120 A 1x μ -contact, NO contact with tungsten pre- make contact, additional NC- safety contact
Type of contact (k):	
Follow-up time:	15 sec - 30 min, Pulse
Switch-on threshold:	10 - 2000 Lux
Light measuring:	Mixed light measuring

Product information

Set : PD4-M-1C-C-PS-FC + Wire basket BSK (Ø 200 x 90 mm) white + Square design frame PD4-FC pure white mat, similar to RAL9010

Occupancy detector with NO contact and safety circuit by NC contact

Guarantees illumination even if sensor fails

Designed for corridors

Version as master device

Detection area can be extended by using slave devices

Manual switching via push-button possible

Additional functions can be set up using the optional remote control.

Factory settings 10 min and 500 lux

There are markings to ensure correct alignment during installation

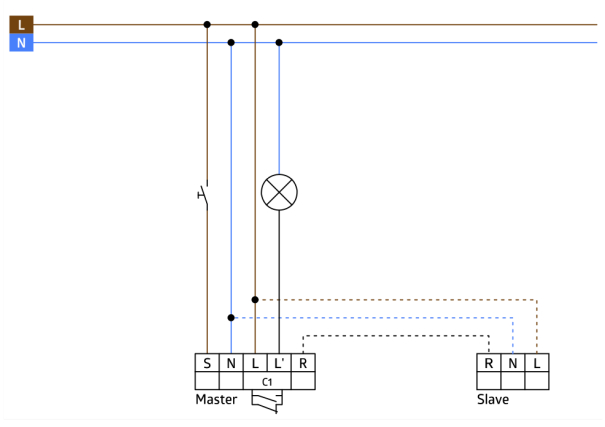
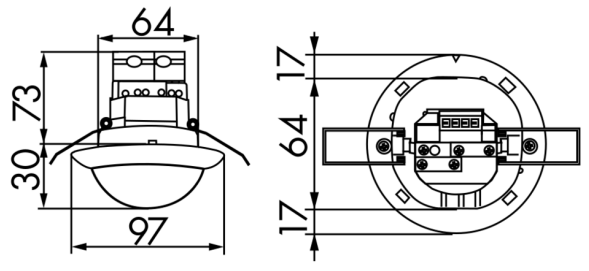

Set items

To receive the bundle according to the technical specification, please order the items listed.



PD4-M-1C-C-PS-FC

Art.No: 92480

Voltage: 110 – 240 V AC 50 / 60 Hz

Dimensions: Ø 97 x 103 mm

Power consumption: approx. 0.7 W



Wire basket BSK (Ø 200 x 90 mm)

Art.No: 92199

Dimensions: Ø 200 x 90 mm

Impact strength: IK09

Housing: coated steel basket



Square design frame PD4-FC

Art.No: 92992

Dimensions: 101 x 101 x 11.8 mm

Housing: polycarbonate, UV-resistant

Material color: pure white mat, similar to RAL9010