

B.E.G.**LUXOMAT®**

BL4-FC

Prod.No. 93288 EAN: 4007529932887

- Voltage: 110 – 240 V AC 50 / 60 Hz
- Dimensions: Ø 104.5 x 84 mm
- Power consumption: approx. 0.3 W

Areas of application

- entrance halls
- corridors/hallways
- toilets
- equipment rooms
- small offices
- open-plan offices
- conference rooms

Order data

Designation	Colour	Art.No
BL4-FC	white	93288

Accessories

Designation	Colour	Art.No
RC-Arc extinction kit	white	10880
Mini-RC-Arc extinction kit		10882
BLE-IR-Adapter	black	93067
IR-BL	-	93055
Wire basket BSK (Ø 200 x 90 mm)	white	92199
Mounting set BL4-SM	white	93183
Mounting set BL4-FM	white	93194

Technical data

Voltage:	110 – 240 V AC 50 / 60 Hz
Dimensions:	Ø 104.5 x 84 mm
Power consumption:	approx. 0.3 W horizontal 360°
Detection area:	(Ceiling mounting) max. Ø 19 m across max. Ø 6.4 m towards max. Ø 5 m seated
Range:	
Monitored area (tangential movement):	280 m ² / 2.5 m mounting height
Mounting height min./max./recommended:	2 m / 5 m / 2.5 m
Degree / class of protection:	IP20 / Class II
Impact strength:	IK04
Ambient temperature:	-25 °C to +50 °C
Housing:	polycarbonate, UV-resistant
Material color:	white mat, similar to RAL9010
Connections and wires:	0.5 – 2.5 mm ² for solid conductors

Channel 1 (lighting control)

Switching power:	1000 W, $\cos \varphi$ = 1 500 VA, $\cos \varphi$ = 0.5 400 W LED
Type of contact (k):	1x μ -contact, NO contact
Follow-up time:	15 sec – 60 min
Switch-on threshold:	10 – 2000 Lux

Product information

Ceiling motion detector for indoor use with a 360° detection area

For mounting in suspended ceilings

One channel for light switching

Manual switching via push-button possible

Easy operation with remote control (required)

Basic functions for cost-effective applications

Ready-to-operate thanks to factory settings

Accessory for surface mounting and flush mounting available

Factory setting: High detection sensitivity, follow-up time 10 min, switch-on threshold 500 lux

Application examples:

entrance halls, corridors/hallways, toilets, equipment rooms, small offices, open-plan offices, conference rooms

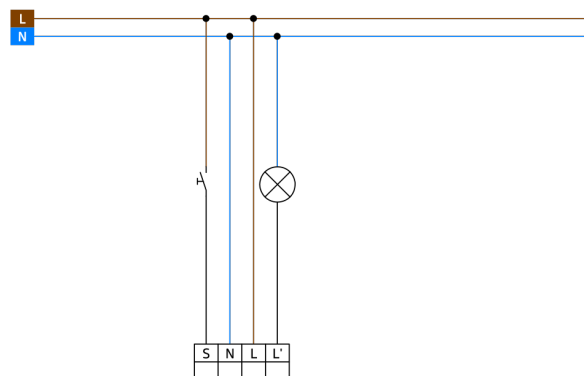
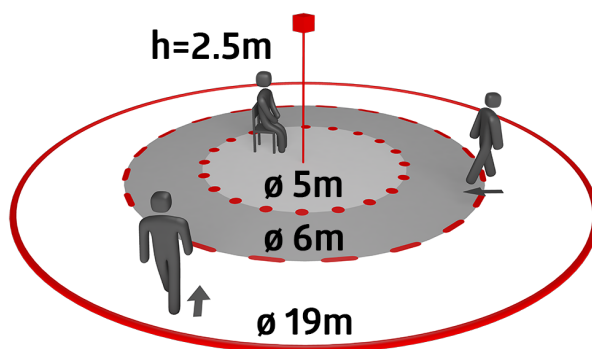
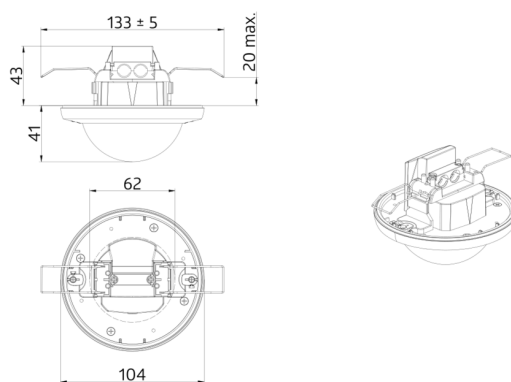

Accessories



RC-Arc extinction kit

Art.No: 10880

Voltage: 230 V AC $\pm 10\%$
Dimensions: 38 x 12 x 26 mm
Degree / class of protection: IP20 / Class II



Mini-RC-Arc extinction kit

Art.No: 10882

Voltage: 230 V AC $\pm 10\%$
Dimensions: 50 x 23 x 8 mm
Degree / class of protection: IP20 / Class II



BLE-IR-Adapter

Art.No: 93067

Dimensions: 40 x 55 x 103 mm
Material color: black
Frequency: 2.4 GHz ISM band, GFSK
0.2 dBm + 5.3 dBi = 5.5 dBm

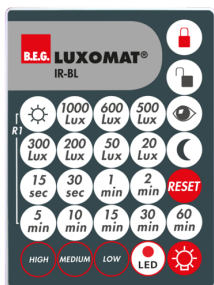

IR-BL

Art.No: 93055

Battery: 3.0 V Lithium CR2032 (inclusive)
Dimensions: 80 x 60 x 8 mm
Housing: polycarbonate, UV-resistant

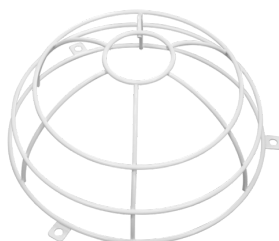

Wire basket BSK (Ø 200 x 90 mm)

Art.No: 92199

Dimensions: Ø 200 x 90 mm
Impact strength: IK09
Housing: coated steel basket



Mounting set BL4-SM

Art.No: 93183

Dimensions: Ø 109 x 34 mm
Impact strength: IK06
Material color: white



Mounting set BL4-FM

Art.No: 93194

Dimensions: Ø 77 x 4.2 mm
Material color: white