

**B.E.G.**

**LUXOMAT®**



## BL2-PLUS-FC Set 93405-92199

Remote control-capable occupancy detector for  
inside use with circular detection area

For mounting in suspended ceilings

One channel for light switching

### Order data

#### Designation

BL2-PLUS-FC

Wire basket BSK (Ø 200 x 90 mm)

#### Colour

white

white

#### Art.No

93405

92199

## Technical data

Voltage:	110 - 240 V 50 / 60 Hz
Dimensions:	<b>Ø 200 x 90 mm (92199)</b>
Power consumption:	0.3 W
Detection area:	horizontal 360° (Ceiling mounting) max. Ø 8 m across max. Ø 4.8 m towards seated
Range:	50 m <sup>2</sup> / 2.5 m mounting height
Monitored area (tangential movement):	2 m / 5 m / 2.5 m
Mounting height min./max./recommended:	IP23 / Class II
Degree / class of protection:	-25 °C to +50 °C
Ambient temperature:	<b>polycarbonate, UV-resistant + coated steel basket (92199)</b>
Housing:	white
Material color:	0.5 - 1.5 mm <sup>2</sup> for solid conductors
Connections and wires:	
<b>Channel 1 (lighting control)</b>	
Switching power:	1000 W, cos φ = 1 500 VA, cos φ = 0.5 400 W LED
Type of contact (k):	1x μ-contact, NO contact
Follow-up time:	15 sec - 30 min
Switch-on threshold:	10 - 2000 Lux

## Product information

Set : BL2-PLUS-FC + Wire basket BSK (Ø 200 x 90 mm) white

Remote control-capable occupancy detector for inside use with circular detection area

For mounting in suspended ceilings

One channel for light switching

Manual switching via push-button possible

Basic functions for cost-effective applications

Ready-to-operate thanks to factory settings

Accessory for surface mounting and flush mounting available

Factory setting: High detection sensitivity, follow-up time 10 min, switch-on threshold 500 lux

### Easy operation with remote control (required)

High-performance relay designed for 100,000 switching cycles under high load, several million switching cycles possible under low load

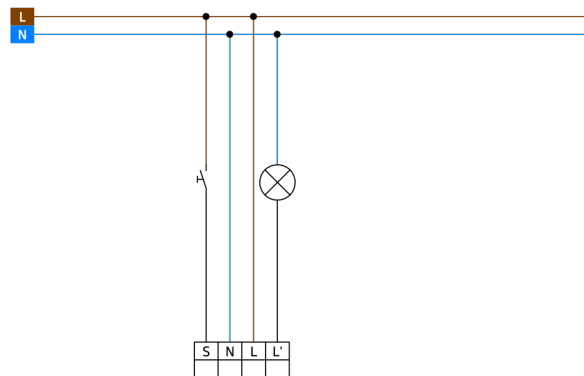
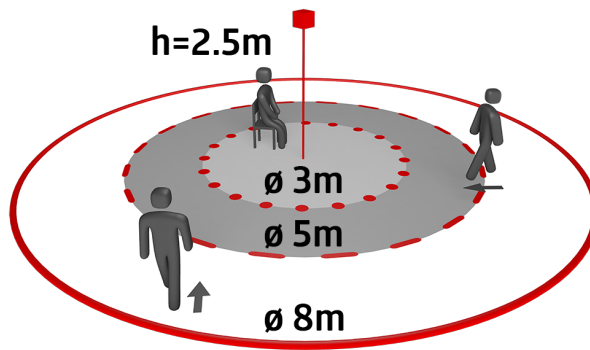
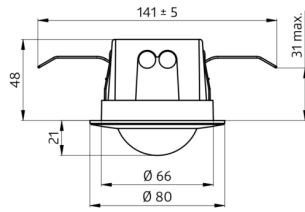



## Set items

To receive the bundle according to the technical specification, please order the items listed.



**BL2-PLUS-FC**  
Art.No: 93405

Voltage: 110 – 240 V 50 / 60 Hz  
Dimensions: Ø 80 x 61 mm  
Power consumption: 0.3 W

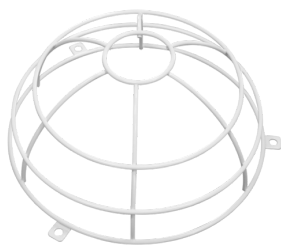

**Wire basket BSK (Ø 200 x 90 mm)**  
Art.No: 92199

Dimensions: Ø 200 x 90 mm  
Impact strength: IK09  
Housing: coated steel basket