

B.E.G.**LUXOMAT®**

Indoor 180-R-11-48V-3A covering not included Bundle 92666-92141

- Voltage: 11 – 48 V AC / DC
- Dimensions: 88 x 88 x 42 mm (92141)
- Power consumption: approx. 1 W

Order data

Designation	Colour	Art.No
Indoor 180-R-11-48V-3A covering not included Bundle 92666-92141	-	506936228

Areas of application

- entrance halls
- corridors/hallways
- staircases
- toilets
- equipment rooms

Technical data

Voltage:	11 – 48 V AC / DC
Dimensions:	88 x 88 x 42 mm (92141)
Power consumption:	approx. 1 W
Detection area:	horizontal 180° (Wall mounting)
Range:	max. 10 m across max. 3 m towards
Monitored area (tangential movement):	150 m² / 1.1 m mounting height
Mounting height min./max./recommended:	1 m / 2.2 m / 1.1 m
Degree / class of protection:	IP54 (92141)
Impact strength:	IK05
Ambient temperature:	-25 °C to +50 °C
Housing:	polycarbonate, UV-resistant
Material color:	-
Channel 1 (lighting control, potential-free (dry))	
Switching power:	3 A; $\cos \varphi = 1$
Type of contact (k):	μ-contact, dry NO contact
Follow-up time:	15 sec – 16 min, Pulse
Switch-on threshold:	5 – 2000 Lux

Product information

Bundle : Indoor 180-R-11-48V-3A covering not included
+ Surface mounting socket Indoor 180 pure white mat, similar to RAL9010

Wall motion detector with acoustic sensor, operating voltage 11-48 V

One potential-free switching channel

Acoustic sensor independently adjustable

Noise automatically extends follow-up time

Manual switching via push-button possible

Available with covering (centre plate dimensions 60 x 60 mm) or without covering for use with covering (centre plate dimensions 50 x 50 mm) in 5 different colours

In combination with centre plates usable with current frame systems of various manufacturers

B.E.G. frames and centre plates for combination with other frame systems available

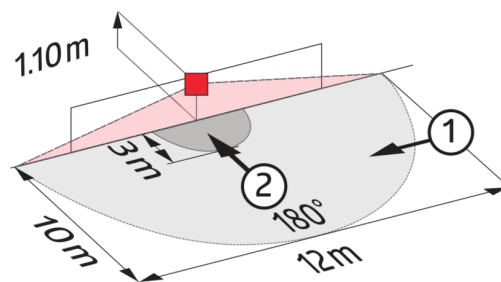
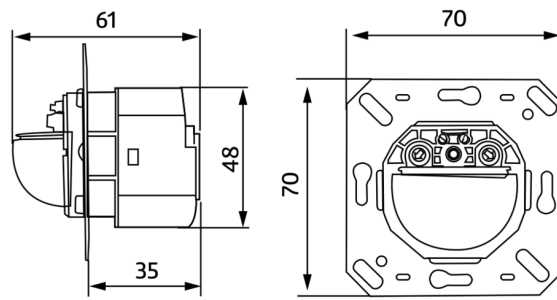

Bundle items

To receive the bundle according to the technical specification, please order the items listed.



Indoor 180-R-11-48V-3A covering not included
Art.No: 92666

Voltage: 11 – 48 V AC / DC

Dimensions: 92666= covering not included 70 x 70 x 61 mm

Power consumption: approx. 1 W



Surface mounting socket Indoor 180
Art.No: 92141

Dimensions: 88 x 88 x 42 mm

Degree / class of protection: IP54

Impact strength: IK05