

Ceiling mounted occupancy detectors - DIM-HVAC

PD4-M-DIM-HVAC-3A



white mat, similar to
RAL9010 , Art.-Nr.: 92507

Product Information

- Occupancy detector for daylight-dependent lighting control
- 1 - 10 V interface for controlling analog, dimmable ballasts
- Additional switching channel for the following function:
Cut-Off (complete ECG switch-off to avoid standby losses).
- One additional potential-free (dry) contact for HVAC
- Manual switching and dimming via push button possible
- Orientation light function
- Version as master device
- Detection area can be extended by using slave devices
- Additional functions can be set up using the optional remote control.
- Relay with tungsten pre-make contact, optimised for LED loads
- Avoidance of standby losses of the lighting system in accordance with EnEV DIN V 18599-4
- **Application examples:**
corridors/hallways

Technical Data

Voltage: 110 - 240 V AC 50 / 60 Hz

Dimensions: FC= Ø 97 x 103 mm

Power consumption: approx. 0,6 W

Detection area:	horizontal 360° (Ceiling mounting)
Range:	max. Ø 24 m across max. Ø 8 m towards max. Ø 6,4 m seated
Monitored area (tangential movement):	450 m ² / 2,5 m mounting height
Mounting height min./max./recommended:	2 m / 10 m / 2,5 m
Degree / class of protection:	FC= IP20 / Class II
Impact strength:	IK04
Ambient temperature:	-25 °C to +50 °C
Housing:	polycarbonate, UV-resistant

Channel 1 (lighting control)

Switching power:	2300 W, cos φ = 1 1150 VA, cos φ = 0,5 300 W LED max. inrush current I _p (20 ms) = 165 A max. inrush current I _p (200 μs) = 800 A
Type of contact:	1x μ-contact, NO contact with tungsten pre-make contact
DIM output:	1 - 10 V DC, up to 50 ballasts
Follow-up time:	1 min - 30 min
Brightness set value:	10 - 2000 Lux

Channel 2 (HVAC control potential-free (dry))

Switching power:	PD4-M-DIM-HVAC-3A-FC: 3 A , 230 V, cos φ = 1 PD4-M-DIM-HVAC-16A-FC: 16 A , 230 V, cos φ = 1
Type of contact:	dry NO contact
Follow-up time:	5 min - 120 min, Alarm pulse, Pulse Mixed light measuring

Description

Description	Colour	Part number	EAN number
PD4-M-DIM-HVAC-3A-FC	white mat, similar to RAL9010	92507	4007529925070

Accessory

Description	Colour	Part number	EAN number
BLE-IR-Adapter	black	93067	4007529930678
IR-PD-DIM-HVAC	-	92114	4007529921140

Description	Colour	Part number	EAN number
IR-PD-DIM-Mini	-	92098	4007529920983
Wire basket BSK (Ø 200 x 90 white mm)		92199	4007529921997
RC-Arc extinction kit	white	10880	4007529108800
Mini-RC-Arc extinction kit	black	10882	4007529108824
Square design frame PD4-FC pure white mat, similar to RAL9010		92992	4007529929924

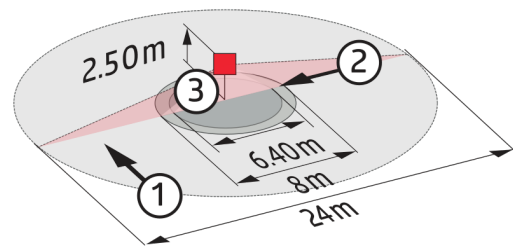
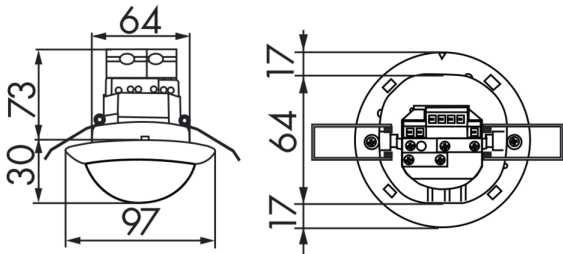

Dimensions 92507

Range diagramm

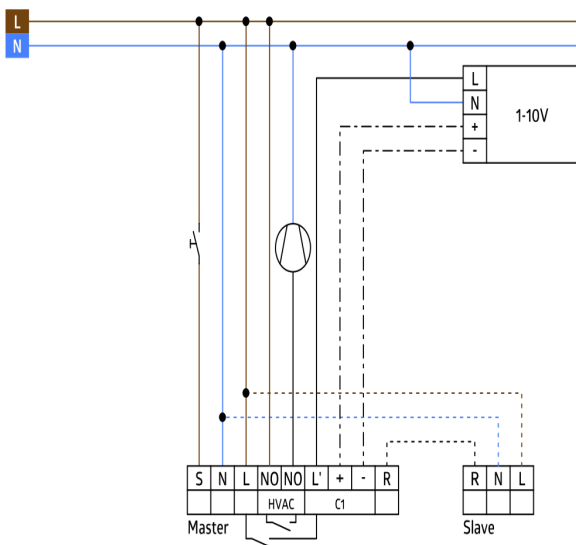

Wiring diagrams

